

## Key Features

- **Dual pump modules** as standard for maximum uptime and redundancy
- **Quick swap** pump modules mean zero downtime and disruption to pipe-work during pump maintenance.
- High output and pressure make large extended systems possible.
  - 400cm<sup>3</sup>/min (24cu. in)
  - 2x200 cm<sup>3</sup>/min Modules
  - 400 Bar (5880 psi)
- Electrical dual line inverter integrates directly onto outlet
- Minimum level capacitance switch and visual maximum level as standard
- Handles Grease NLGI 2

## Advantages

- **Adjustable pump element:** available as optional.
- **Reduced Investment:** with *Dual Pumping Modules*, the system can continue even if one pump module becomes ineffective providing redundancy and reducing need for a complete second standby pump.
- **Fast maintenance:** *Quick swap* pump modules can be replaced in seconds. Pipe work untouched means less contamination
- **Optional HEAT Module** for low temperature eliminates expensive heating bands.
- **Compact modular design:** eliminates external piping of components.

# Pump Series SUMO

The flexible high performance heavy duty electric grease pump solution



**A high performance pump solution for heavy duty applications in demanding environments such as the pulp & paper and steel industry.**

### DUAL PUMPING MODULE

Twin 200cm<sup>3</sup>/min pump modules installed in tandem configuration provide 400bar (5880 psi) and redundancy .

This allows the system to continue working even if one pump module becomes ineffective.

Sumo pump is suitable for large single line or dual line systems.

### INSTRUMENTATION MODULES

Sophisticated add on instrumentation modules and options means even complex requirements can be met with off-the-shelf standard product.

### QUICK SWAP SYSTEM

BOTH **PUMPING MODULES** can be quickly replaced from the front mounting of the pump. No pipe work needs to be disrupted meaning near-zero downtime during maintenance.

### DUAL LINE OR SINGLE LINE IS EASY

The outlet plate fixing system has both Pressure and Return ports. The outlets are directly compatible with Dropsa's electrical or pneumatic line inverters (including Modular version).

## Contacts

[www.dropsa.com](http://www.dropsa.com)  
[sales@dropsa.com](mailto:sales@dropsa.com)

### ITALY

Dropsa SpA  
 t. +39 02-250791  
 f.+39 02-25079767

### U.K.

Dropsa (UK) Ltd  
 t. +44 (0)1784-431177  
 f. +44 (0)1784-438598

### GERMANY

Dropsa GmbH  
 t. +49 (0)211-394-011  
 f. +49 (0)211-394-013

### FRANCE

Dropsa Ame  
 t. +33 (0)1-3993-0033  
 f. +33 (0)1-3986-2636

### SPAIN

Polydrop, S.A.  
 t. +34 (0)93-260-22-50  
 f. +34 (0)93-260-22-51

### U.S.A.

Dropsa Corporation  
 t. +1 586-566-1540  
 f. +1 586-566-1541

### AUSTRALIA

Dropsa Australia Ltd.  
 t. +61 (0)2-9938-600644  
 f. +61 (0)2-9938-6611

### BRAZIL

Dropsa  
 t. +55 (0)11-563-10007  
 f. +55 (0)11-563-19408

## Technical Information

### TECHNICAL CHARACTERISTICS

Max. Pressure	400 bar
Output Flow Delivery	400 cm <sup>3</sup> / min (24 cu. in/min) (2 x 200 cm <sup>3</sup> (12 cu. in) pumping modules)
Operating Temperature	- 5° C to + 40° C (-4° to +104° F)
Operating Humidity	90% max
<b>Mineral Oil Lubricant</b>	
Viscosity at operating temperature	Min. 32 cSt max. 1000 cSt Note: Requires Oil conversion kit for level and fill modification.
<b>Grease Lubricant</b>	
Viscosity at operating temperature	Max. NGLI 2

### DIMENSIONS MM (INCHES)

A	1020 (40.15), reservoir 30 kg 1350 (53.14), reservoir 100 kg
B	615 (24.21), reservoir 30-100 kg
C	460 (18.11), reservoir 30-100 kg

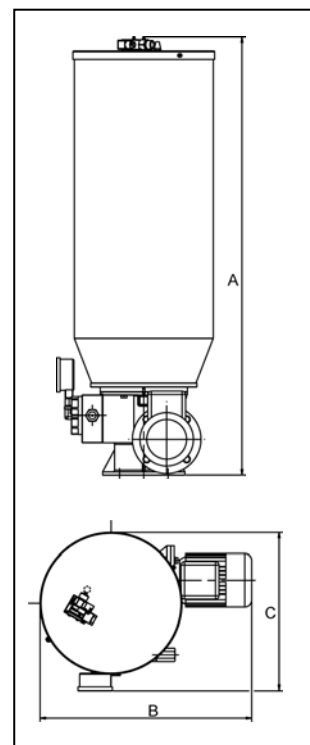

### STANDARD EQUIPMENT

Electric Motor	Three phase 0.75kW, Grade of protection IP55 class B Voltage: 220-380 Volt ± 5% 50 Hz 240-440Volt ± 5% 60 Hz S1 Continuous Duty.
Reservoir	30 kg (66lb) or 100 kg (220 lb)
Level Indicator	Low Level capacitance level electrical signal (PNP) Visual maximum level
Adjustable By-Pass	200-400 bar (2950 – 5800 psi) 350 Bar (5000 psi) Standard setting
Electrical Inverter Module	24V DC Inverter for pump outlet 110V AC 50/60Hz Inverter for pump outlet 230V AC 50/60HZ Inverter for pump outlet
Filling	Filling valve with filter
Pressure gauge	0-600 bar (0-8800 psi) Front mounted

## Ordering, Optional Add-ons and Instrumentation

Standard Equipment		
EQUIPMENT	DESCRIPTION	PART No.
SUMO PUMP PACKAGE	Grease pump 400 cm <sup>3</sup> /min w/30 Kg reservoir	<b>Three-phase</b> S-00195-B3
	Grease pump 400 cm <sup>3</sup> /min w/100Kg reservoir	S-00195-A3
Dual line electrical inverter	Base plate module for inverter +	
	24V DC	0083430
	110V AC 50/60Hz	0083431
	230V AC 50/60HZ	0083432
Optional Add-ons and Instrumentation		
Ultrasound Level Instruments	Ultra sounds level switch continuous reading 4..20mA	S-00195-UTC
	Ultra sounds level switch with digital outputs	S-00195-UTD
HEAT Module	Heating module for low temperature operation below -5°C (23° F)	S-00195-HTG
Pump Modules	Spare 200cm <sup>3</sup> /min (24 cu. in) pump module	S-00195-P1
	Adjustable 100 - 200cm <sup>3</sup> /min (12-24 cu. in) pump module.	S-00195-P6
	Blanking plug for unused pump cavity	S-00195-154
Oil conversion	Conversion kit for Oil system 30 Kg (66lb) w/filler cap	S-00195-KO1
	Conversion kit for Oil system 100 Kg (220lb) w/filler cap	S-00195-KO2

Note: For other customized applications please contact DropsA technical-sales offices.